

Equal Leg Angles

A		B		C		Approx. weight per foot	Approx. weight per meter
inch	mm	inch	mm	inch	mm	lbs.	Kg
1.25	31.75	1.25	31.75	0.188	4.775	1.51	0.69
1.50	38.10	1.50	38.10	0.188	4.775	1.82	0.83
1.75	44.45	1.75	44.45	0.188	4.775	2.13	0.97
2.00	50.80	2.00	50.80	0.188	4.775	2.47	1.12
2.50	63.50	2.50	63.50	0.188	4.775	3.09	1.40
3.00	76.20	3.00	76.20	0.188	4.775	3.78	1.71
1.25	31.75	1.25	31.75	0.250	6.350	1.89	0.86
1.50	38.00	1.50	38.00	0.250	6.350	2.37	1.07
1.75	44.45	1.75	44.45	0.250	6.350	2.87	1.26
2.00	50.80	2.00	50.80	0.250	6.350	3.23	1.46
2.50	63.50	2.50	63.50	0.250	6.350	4.12	1.87
3.00	76.20	3.00	76.20	0.250	6.350	4.94	2.24
3.50	88.90	3.50	88.90	0.250	6.350	5.80	2.63
4.00	101.60	4.00	101.60	0.250	6.350	6.69	3.04
2.00	50.80	2.00	50.80	0.313	7.950	3.98	1.81
2.50	63.50	2.50	63.50	0.313	7.950	5.01	2.27
3.00	76.20	3.00	76.20	0.313	7.950	6.14	2.79
3.50	88.90	3.50	88.90	0.313	7.950	7.17	3.25
4.00	101.60	4.00	101.60	0.313	7.950	8.27	3.75
2.00	50.80	2.00	50.80	0.375	9.525	4.67	2.12
2.50	63.50	2.50	63.50	0.375	9.525	6.01	2.72
3.00	76.20	3.00	76.20	0.375	9.525	7.31	3.32
3.50	88.90	3.50	88.90	0.375	9.525	8.51	3.86
4.00	101.60	4.00	101.60	0.375	9.525	9.82	4.45
1.63	41.28	1.63	41.28	0.500	12.70	4.70	2.13
2.50	63.50	2.50	63.50	0.500	12.70	7.76	3.52
3.00	76.20	3.00	76.20	0.500	12.70	9.47	4.23
3.50	88.90	3.50	88.90	0.500	12.70	11.15	5.06
4.00	101.60	4.00	101.60	0.500	12.70	12.87	5.84

Structural Shipping Tolerances:

999 lbs. and under (up to 449 kg)	+25% / -10%
1,000 to 4,999 lbs. (450 – 2249 kg)	+/- 10%
25,000 lbs. and over (2250 kg and over)	+/- 5%

Compare Our Cost and Quality Benefits

Plymouth near-net extrusions provide a tremendous advantage over alternative metalworking methods such as forging, welding, brakeforming and machining from bar or plate stock. The Plymouth advantage includes:

- Cost savings due to efficient material usage and reduced scrap
- Design flexibility and assistance
- No tooling charges
- Simplified production with less machining and finishing
- Excellent product quality, dimensional consistency and surface finish
- Superior customer service

The following specifications can be applied to structural products:

ASTM A 276 ASTM A 479

All items shall be furnished in the as extruded, annealed and pickled and cold stretch straightened condition with a uniform matte finish.

Grades available in Titanium, Carbon Steel, Alloy Steel and Stainless Steel.

PLYMOUTH EXTRUDED SHAPES

A member of the



201 Commerce Court, Hopkinsville, KY 42240 USA Call Toll Free 1.800.718.7590
Phone: 1.270.886.6631 FAX: 1.270.886.6662 E-Mail: extrusions@plymouth.com

© 2001, Plymouth Extruded Shapes



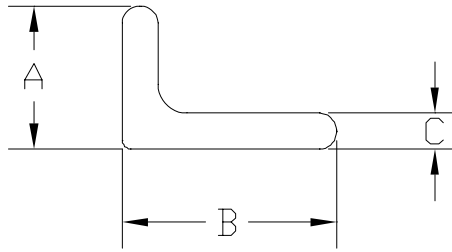

Unequal Leg Angles

A		B		C		Approx. weight per foot	Approx. weight per meter	A		B		C		Approx. weight per foot	Approx. weight per meter
inch	mm	inch	mm	inch	mm			inch	mm	inch	mm	inch	mm		
0.75	19.05	1.50	38.10	0.188	4.775	1.37	0.62	3.00	76.20	4.00	101.60	0.313	7.950	7.17	3.25
1.00	25.40	2.00	50.80	0.188	4.775	1.79	0.81	3.00	76.20	2.00	50.80	0.313	7.950	5.00	2.27
1.50	38.10	2.00	50.80	0.188	4.775	2.16	0.98	3.50	88.90	2.50	63.50	0.313	7.950	6.10	2.77
1.75	44.45	2.00	50.80	0.188	4.775	2.30	1.04	4.00	101.60	3.00	76.20	0.313	7.950	7.20	3.27
2.00	50.80	1.50	38.10	0.188	4.775	2.12	0.96	1.50	38.10	2.50	63.50	0.375	9.525	4.67	2.12
2.00	50.80	2.50	63.50	0.188	4.775	2.78	1.26	1.50	38.10	3.00	76.20	0.375	9.525	5.18	2.35
2.00	50.80	3.00	76.20	0.188	4.775	3.09	1.40	1.50	38.10	5.32	135.10	0.375	9.525	8.24	3.74
2.25	57.15	3.00	76.20	0.188	4.775	3.26	1.48	2.00	50.80	2.50	63.50	0.375	9.525	5.32	2.41
2.50	63.50	2.00	50.80	0.188	4.775	2.75	1.25	2.00	50.80	3.00	76.20	0.375	9.525	5.97	2.71
3.00	76.20	2.00	50.80	0.188	4.775	3.07	1.39	2.50	63.50	1.50	38.10	0.375	9.525	4.70	2.13
0.75	19.05	2.00	50.80	0.250	6.350	2.20	1.00	2.50	63.50	2.00	50.80	0.375	9.525	5.30	2.40
1.00	25.40	1.50	38.10	0.250	6.350	1.82	0.83	2.50	63.50	3.50	88.90	0.375	9.525	7.42	3.29
1.00	25.40	2.00	50.80	0.250	6.350	2.37	1.07	3.00	76.20	1.50	38.10	0.375	9.525	5.30	2.40
1.25	31.75	2.50	63.50	0.250	6.350	3.00	1.35	3.00	76.20	3.50	88.90	0.375	9.525	7.83	3.55
1.50	38.10	1.00	25.40	0.250	6.350	1.92	0.87	3.00	76.20	4.00	101.60	0.375	9.525	8.51	3.86
1.50	38.10	2.00	50.80	0.250	6.350	3.09	1.40	3.00	76.20	5.00	127.00	0.375	9.525	9.85	4.47
1.50	38.10	2.50	63.50	0.250	6.350	3.19	1.45	1.00	25.40	3.00	76.20	0.500	12.70	6.01	2.72
1.50	38.10	3.00	76.20	0.250	6.350	3.64	1.65	1.50	38.10	2.25	57.15	0.500	12.70	5.56	2.52
2.00	50.80	1.00	25.40	0.250	6.350	2.34	1.06	1.50	38.10	3.00	76.20	0.500	12.70	6.86	3.11
2.00	50.80	1.50	38.10	0.250	6.350	2.77	1.26	1.50	38.10	3.50	88.90	0.500	12.70	7.72	3.50
2.00	50.80	2.50	63.50	0.250	6.350	3.67	1.67	2.00	50.80	3.00	76.20	0.500	12.70	7.72	3.50
2.00	50.80	3.00	76.20	0.250	6.350	4.08	1.85	2.50	63.50	3.50	88.90	0.500	12.70	9.47	4.30
2.50	63.50	1.25	31.75	0.250	6.350	2.85	1.29	3.00	76.20	3.50	88.90	0.500	12.70	10.43	4.73
2.50	63.50	1.50	38.10	0.250	6.350	3.19	1.45	3.00	76.20	4.00	101.60	0.500	12.70	11.26	5.12
2.50	63.50	2.00	50.80	0.250	6.350	3.62	1.64	3.00	76.20	4.50	114.30	0.500	12.70	12.05	5.46
2.50	63.50	3.00	76.20	0.250	6.350	4.50	2.04	3.00	76.20	5.00	127.00	0.500	12.70	12.97	5.89
2.50	63.50	3.50	88.90	0.250	6.350	4.94	2.24	4.00	101.60	3.50	88.90	0.500	12.70	12.05	5.46
3.00	76.20	1.50	38.10	0.250	6.350	3.51	1.59								
3.00	76.20	2.00	50.80	0.250	6.350	4.10	1.86								
3.00	76.20	2.50	63.50	0.250	6.350	4.50	2.04								
3.00	76.20	3.50	88.90	0.250	6.350	5.39	2.44								
3.00	76.20	4.00	101.60	0.250	6.350	5.83	2.65								
3.50	88.90	2.50	63.50	0.250	6.350	4.90	2.22								
3.50	88.90	3.00	76.20	0.250	6.350	5.40	2.45								
4.00	101.60	3.00	76.20	0.250	6.350	5.80	2.63								
4.00	101.60	3.50	88.90	0.250	6.350	6.25	2.83								
2.00	50.80	3.00	76.20	0.313	7.950	5.01	2.27								
2.50	63.50	3.50	88.90	0.313	7.950	6.11	2.77								

The following specifications can be applied to structural products:

ASTM A 276 ASTM A 479

All items shall be furnished in the as extruded, annealed and pickled and cold stretch straightened condition with a uniform matte finish.

Grades available in Titanium, Carbon Steel, Alloy Steel and Stainless Steel.

PLYMOUTH EXTRUDED SHAPES

A member of the



PLYMOUTH TUBE CO^{USA}

201 Commerce Court, Hopkinsville, KY 42240 USA Call Toll Free 1.800.718.7590
Phone: 1.270.886.6631 FAX: 1.270.886.6662 E-Mail: extrusions@plymouth.com

© 2001, Plymouth Extruded Shapes



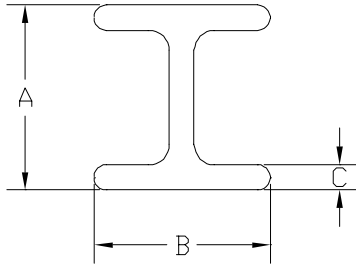

BEAMS

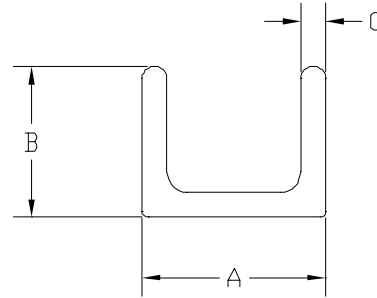

CHANNELS

A		B		C		Approx. weight per foot	Approx. weight per meter
inch	mm	inch	mm	inch	mm	lbs.	Kg
1.50	38.10	1.00	25.40	0.188	4.775	1.79	0.81
1.50	38.10	1.00	25.40	0.188	4.775	2.02	0.92
1.50	38.10	1.00	25.40	0.250	6.350	2.64	1.20
2.00	50.80	1.25	31.75	0.250	6.350	3.47	1.57
2.50	63.50	1.50	38.10	0.250	6.350	4.29	1.95
3.00	76.20	2.38	60.33	0.250	6.350	6.80	3.08
3.00	76.20	3.00	76.20	0.250	6.350	7.72	3.50
4.00	101.60	2.75	69.85	0.250	6.350	8.44	3.83
4.00	101.60	2.66	67.64	0.250	6.350	9.13	4.14

A		B		C		Approx. weight per foot	Approx. weight per meter
inch	mm	inch	mm	inch	mm	lbs.	kg
1.50	38.10	0.75	19.05	0.188	4.775	1.72	0.78
2.00	50.80	0.56	14.28	0.188	4.775	1.82	0.83
2.00	50.80	0.63	15.88	0.188	4.775	1.85	0.84
2.00	50.80	0.75	19.05	0.188	4.775	2.00	0.91
2.00	50.80	1.00	25.40	0.188	4.775	2.71	1.23
2.50	63.50	0.63	15.88	0.188	4.775	2.23	1.01
3.00	76.20	1.00	25.40	0.188	4.775	3.00	1.36
3.00	76.20	1.00	25.40	0.188	4.775	3.02	1.37
3.00	76.20	1.25	31.75	0.188	4.775	3.30	1.50
3.00	76.20	1.38	34.93	0.188	4.775	4.30	1.95
3.00	76.20	1.50	38.10	0.188	4.775	3.71	1.68
1.25	31.75	1.00	25.40	0.250	6.350	2.40	1.09
1.50	38.10	1.00	25.40	0.250	6.350	2.92	1.33
2.00	50.80	0.63	15.88	0.250	6.350	2.37	1.08
2.00	50.80	1.00	25.40	0.250	6.350	3.00	1.36
2.00	50.80	1.00	25.40	0.250	6.350	2.95	1.34
2.00	50.80	1.50	38.10	0.250	6.350	3.91	1.77
2.25	57.15	1.00	25.40	0.250	6.350	3.26	1.48
2.50	63.50	1.00	25.40	0.250	6.350	3.43	1.56
3.00	76.20	1.00	25.40	0.250	6.350	3.91	1.77
3.00	76.20	1.50	38.10	0.250	6.350	4.77	2.16
3.00	76.20	1.50	38.10	0.250	6.350	4.81	2.18
4.00	101.60	1.75	44.45	0.250	6.350	6.62	3.00
4.00	101.60	1.75	44.45	0.250	6.350	6.04	2.74
5.00	127.00	1.88	47.63	0.375	9.525	10.43	4.73
3.50	88.90	3.00	76.20	0.500	12.70	17.40	7.89
4.00	101.60	2.00	50.80	0.500	12.70	12.05	5.47

Structural Shipping Tolerances:

999 lbs. and under (up to 449 kg)	+25% / -10%
1,000 to 4,999 lbs. (450 – 2249 kg)	+/- 10%
25,000 lbs. and over (2250 kg and over)	+/- 5%

Practical Solutions for Streamlining Production Steps

- A wide range of sizes and configurations, materials and grades to meet your strength and performance requirements.
- Versatile design capabilities help reduce or eliminate welding and other assembly steps.
- No rolled-in scale. Better surface as extruded means faster, easier finishing.
- Plymouth's low, one-time design charge facilitates inexpensive design charges.

The following specifications can be applied to structural products:

ASTM A 276 ASTM A 479

All items shall be furnished in the as extruded, annealed and pickled and cold stretch straightened condition with a uniform matte finish.

Grades available in Titanium, Carbon Steel, Alloy Steel and Stainless Steel.

PLYMOUTH EXTRUDED SHAPES

A member of the



201 Commerce Court, Hopkinsville, KY 42240 USA Call Toll Free 1.800.718.7590
Phone: 1.270.886.6631 FAX: 1.270.886.6662 E-Mail: extrusions@plymouth.com

© 2001, Plymouth Extruded Shapes



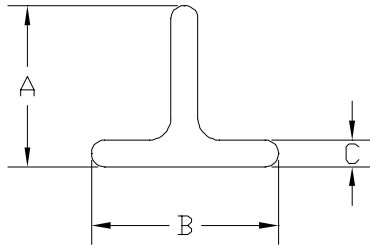

TEES

Compare Our Cost and Quality Benefits

Plymouth near-net extrusions provide a tremendous advantage over alternative metalworking methods such as forging, welding, brakeforming and machining from bar or plate stock. The Plymouth advantage includes:

- Cost savings due to efficient material usage and reduced scrap
- Design flexibility and assistance
- No tooling charges
- Simplified production with less machining and finishing
- Excellent product quality, dimensional consistency and surface finish
- Superior customer service

A		B		C		Approx. weight per foot	Approx. weight per meter
inch	mm	inch	mm	inch	mm	lbs.	Kg
1.50	38.10	1.00	25.40	0.188	4.775	1.51	0.69
1.50	38.10	1.50	38.10	0.188	4.775	1.85	0.84
1.50	38.10	2.00	50.80	0.188	4.775	2.09	0.95
1.50	38.10	2.38	60.33	0.188	4.775	2.40	1.09
1.25	31.75	2.00	50.80	0.188	4.775	1.92	0.87
2.00	50.80	1.25	31.75	0.188	4.775	2.00	0.91
2.00	50.80	2.00	50.80	0.188	4.775	2.47	1.12
3.00	76.20	1.88	47.63	0.188	4.775	3.05	1.39
1.00	25.40	1.25	31.75	0.250	6.350	1.75	0.79
1.25	31.75	1.25	31.75	0.250	6.350	1.96	0.89
1.25	31.75	3.25	82.55	0.250	6.350	3.67	1.67
1.50	38.10	1.50	38.10	0.250	6.350	3.36	1.53
1.50	38.10	2.00	50.80	0.250	6.350	2.81	1.28
1.63	41.28	1.38	34.93	0.250	6.350	2.40	1.09
2.00	50.80	1.25	31.75	0.250	6.350	2.61	1.18
2.00	50.80	1.75	44.45	0.250	6.350	2.99	1.35
2.00	50.80	2.00	50.80	0.250	6.350	3.26	1.48
2.50	63.50	1.50	38.10	0.250	6.350	3.19	1.45
2.50	63.50	2.50	63.50	0.250	6.350	4.15	1.88
2.75	69.85	4.00	101.60	0.250	6.350	5.60	2.54
3.00	76.20	3.00	76.20	0.250	6.350	6.69	3.04
4.00	101.60	4.00	101.60	0.250	6.350	6.66	3.02
1.00	25.40	1.75	44.45	0.312	7.925	2.57	1.17
2.50	63.50	2.50	63.50	0.312	7.925	5.08	2.30
1.25	31.75	1.25	31.75	0.375	9.525	2.75	1.25
1.50	38.10	1.50	38.10	0.375	9.525	3.40	1.54
1.50	38.10	3.00	76.20	0.375	9.525	5.35	2.43
2.00	50.80	2.00	50.80	0.375	9.525	4.70	2.13
2.38	60.33	2.00	50.80	0.375	9.525	5.15	2.34
2.50	63.50	2.00	50.80	0.375	9.525	5.29	2.40
2.50	63.50	2.50	63.50	0.375	9.525	6.04	2.74
2.50	63.50	3.00	76.20	0.375	9.525	6.62	3.01
3.00	76.20	1.50	38.10	0.375	9.525	5.35	2.43
2.13	53.98	4.00	101.60	0.375	9.525	6.73	3.05
2.13	53.98	4.00	101.60	0.250	6.350	6.73	3.05
3.50	88.90	3.50	88.90	0.375	9.525	8.61	3.91
2.00	50.80	2.00	50.80	0.500	12.70	6.11	2.77

The following specifications can be applied to structural products:

ASTM A 276 ASTM A 479

All items shall be furnished in the as extruded, annealed and pickled and cold stretch straightened condition with a uniform matte finish.

Grades available in Titanium, Carbon Steel, Alloy Steel and Stainless Steel.

Structural Shipping Tolerances:

999 lbs. and under (up to 449 kg)	+25% / -10%
1,000 to 4,999 lbs. (450 – 2249 kg)	+/- 10%
25,000 lbs. and over (2250 kg and over)	+/- 5%

PLYMOUTH EXTRUDED SHAPES

A member of the



201 Commerce Court, Hopkinsville, KY 42240 USA Call Toll Free 1.800.718.7590
Phone: 1.270.886.6631 FAX: 1.270.886.6662 E-Mail: extrusions@plymouth.com

© 2001, Plymouth Extruded Shapes

